



SECOND FLOOR APARTMENT
3 Royal Crescent, Bath

Carter Jonas

SECOND FLOOR APARTMENT, 3 ROYAL CRESCENT, BATH

A DELIGHTFUL ONE BEDROOM SECOND FLOOR APARTMENT WITHIN THIS RENOWNED GRADE I LISTED GEORGIAN CRESCENT WITH THE BENEFIT OF LOVELY SOUTH WESTERLY VIEWS AND A SINGLE GARAGE.

- Bath Spa Station 1 mile (London Paddington from 90 minutes)
- M4 (J18) 10 Miles
- Bristol International Airport 20 miles

Communal reception hall • Hallway • Drawing room with dining area • Kitchen • Double bedroom Bathroom • Garage

DESCRIPTION

A lovely second floor apartment at the start of The Royal Crescent, affording lovely elevated views of The Crescent and Royal Victoria Park in a south westerly direction. It has spacious accommodation, the main reception room having three large sash windows with their original wooden shutters and wrought iron balconettes. The kitchen opens into the dining area of the reception room, with access off the main hall, which in turn leads to the bathroom and the double bedroom at the rear of the building, with built in wardrobes. Of particular note is the benefit of a secure single garage that sits at the rear of the building.

SITUATION

The Royal Crescent enjoys renown as the centrepiece of Bath's architectural heritage. Occupying a prime situation on Bath's lower northern slopes, it enjoys commanding views across the city to the south and neighbouring crescents and terraces to the north.

The Royal Crescent is a Grade I Listed semi elliptical crescent that was built by John Wood The Younger in 1767-75 and is one of the greatest examples of Georgian architecture to be found in the United Kingdom. It faces south, overlooking the crescent lawn, down across Royal Victoria Park. It has a renowned architectural appeal and an illustrious history of famous residents over the years.

Bath is a World Heritage site, famous for its Roman heritage and Georgian architecture. Bath offers a wealth of shopping, entertainment, leisure and cultural facilities as well as a mainline rail link to London Paddington (journey time approx 90 minutes) and Bristol Temple Meads (journey time approx 15 minutes). Junction 18 of the M4 motorway is approximately 10 miles to the north. There are excellent schools in both the private and state sectors, a short distance away - namely King Edwards Primary School, and the Royal High School and Kingswood on Lansdown.

ADDITIONAL INFORMATION

Tenure	Long Leasehold
Services	All mains services are connected
Viewing	Strictly by appointment through Carter Jonas

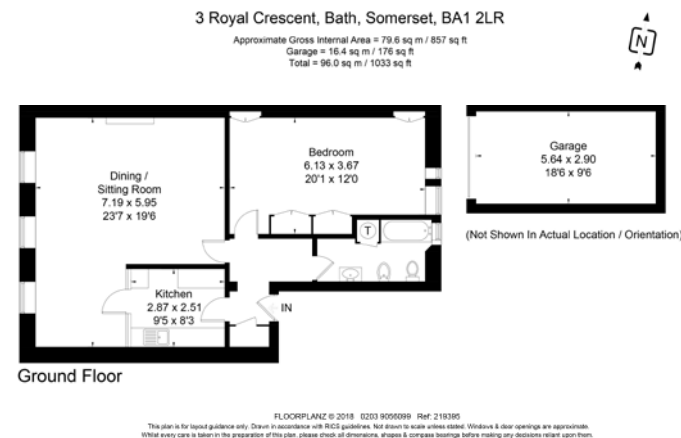

Bath 01225 747270

bath@carterjonas.co.uk

St James House, Lower Bristol Road, Bath BA2 3BH



carterjonas.co.uk

Offices throughout the UK

IMPORTANT INFORMATION

These particulars are for general information purposes only and do not represent an offer of contract or part of one. Carter Jonas has made every attempt to ensure that the particulars and other information provided are as accurate as possible and are not intended to amount to advice on which you should rely as being factually accurate. You should not assume that the property has all necessary planning, building regulations or other consents and Carter Jonas have not tested any services, facilities or equipment. Any measurements and distances given are approximate only. Purchasers must satisfy themselves of all of the aforementioned by independent inspection or otherwise. Although we make reasonable efforts to update our information, neither Carter Jonas LLP nor anyone in its employment or acting on its behalf makes any representations warranties or guarantees, whether express or implied, in relation to the property, or that the content in these particulars is accurate, complete or up to date. Our images only represent part of the property as it appeared at the time they were taken. If you require further information please contact us.