



FOXBURY PLACE  
GREAT BEDWYN

Carter Jonas



# 13 FOXBURY PLACE, GREAT BEDWYN, MARLBOROUGH, SN8 3PL

## AMENITIES

- Sitting room
- Kitchen
- Conservatory
- Two bedrooms
- Bathroom
- Parking
- Chain free
- Development for the over 55's

## SITUATION

Foxbury Place is situated in the middle of Great Bedwyn, a popular and sought-after village. It is located within an Area of Outstanding Natural Beauty and a Conservation Area on the edge of Savernake Forest. The Kennet and Avon canal runs through the village and there are wonderful countryside walks on the doorstep. The village has a station, shop and post office (with bakery), doctor's surgery and public house.

The market towns of Marlborough and Hungerford offer a more comprehensive selection of shops and leisure facilities, with Swindon being 18 miles away. There is a train station in the village with services to London Paddington (c70 minutes).

## DESCRIPTION

13 Foxbury Place is a spacious and well-designed semi-detached bungalow, specifically designed for those aged 55 and over. Built in 1985 of brick under a tiled roof.

The property has a welcoming and good-sized entrance hallway with a large walk-in coat/storage cupboard. Well-proportioned throughout, the property enjoys a good-sized sitting/dining room with a bay window to front and doors leading to a conservatory.

The kitchen is fitted with a range of units and overlooks the rear patio garden. The property has two bedrooms, a bathroom and a generous storage cupboard. A Lifeline alarm system is fitted within the property, whilst launderette facilities are available in the central complex. The property would benefit from some redecoration and updating.

## OUTSIDE

The property is approached via a courtyard garden. There is access to the communal gardens which are fully maintained as a part of the service charge. The front is paved with a mix of shrubs with a retaining picket fence. The private rear garden is laid to patio with a raised border.

**LOCATED IN THE HEART OF THIS POPULAR WILTSHIRE VILLAGE, THIS IS A WELL PROPORTIONED TWO BEDROOM BUNGALOW WHICH BENEFITS FROM ALLOCATED PARKING AND A PRIVATE PATIO GARDEN TO THE REAR.**



**TENURE** Leasehold (999 years from 24 June 1986)

**EPC BAND** D.

**GUIDE PRICE:** £250,000 (Subject to Contract)

**VIEWING ARRANGEMENTS:** By appointment with the Marlborough Office





Classification L2 - Business Data



Foxbury Place, Great Bedwyn, Marlborough, SN8  
Approximate Area = 701 sq ft / 65.1 sq m

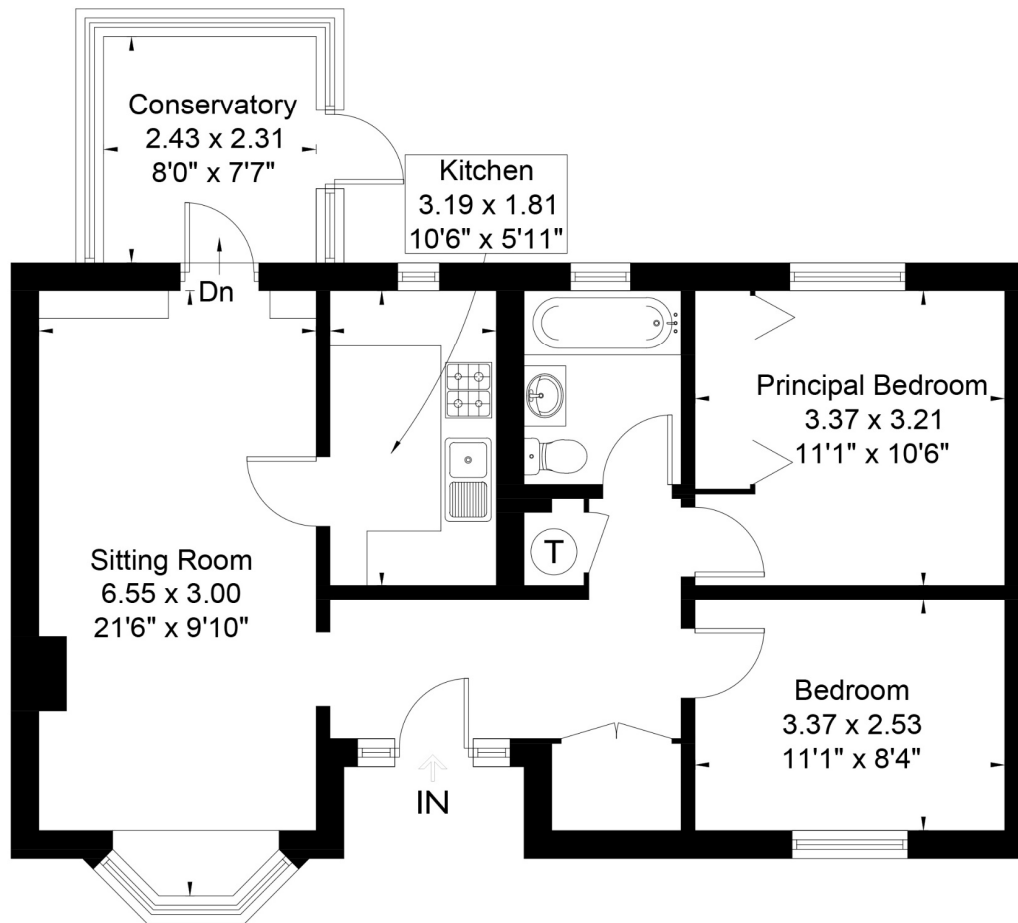
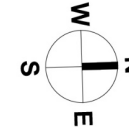

## Ground Floor

Surveyed and drawn in accordance with the International Property Measurement Standards  
fourwalls-group.com 326967

**Marlborough 01672 514 916**  
93 High Street, Marlborough, SN8 1HD

**carterjonas.co.uk**  
Offices throughout the UK

### IMPORTANT INFORMATION

These particulars are for general information purposes only and do not represent an offer of contract or part of one. Carter Jonas has made every attempt to ensure that the particulars and other information provided are as accurate as possible and are not intended to amount to advice on which you should rely as being factually accurate. You should not assume that the property has all necessary planning, building regulations or other consents and Carter Jonas have not tested any services, facilities or equipment. Any measurements and distances given are approximate only. Purchasers must satisfy themselves of all of the aforementioned by independent inspection or otherwise. Although we make reasonable efforts to update our information, neither Carter Jonas LLP nor anyone in its employment or acting on its behalf makes any representations warranties or guarantees, whether express or implied, in relation to the property, or that the content in these particulars is accurate, complete or up to date. Our images only represent part of the property as it appeared at the time they were taken. If you require further information please contact us.

Classification L2 - Business Data